

FB-1000

# FINESBIT

MEASURING RANGE : 100g - 1000g/h

MICROSCALE FEEDING for ULTRAFINE POWDER

HIGH ACCURACY SET VALUE : +/- 3wt.% (Accuracy varies with types of measured material)

Original forced scraping system and special discharge system (PATPEND) provide stable feeding with absolute accuracy

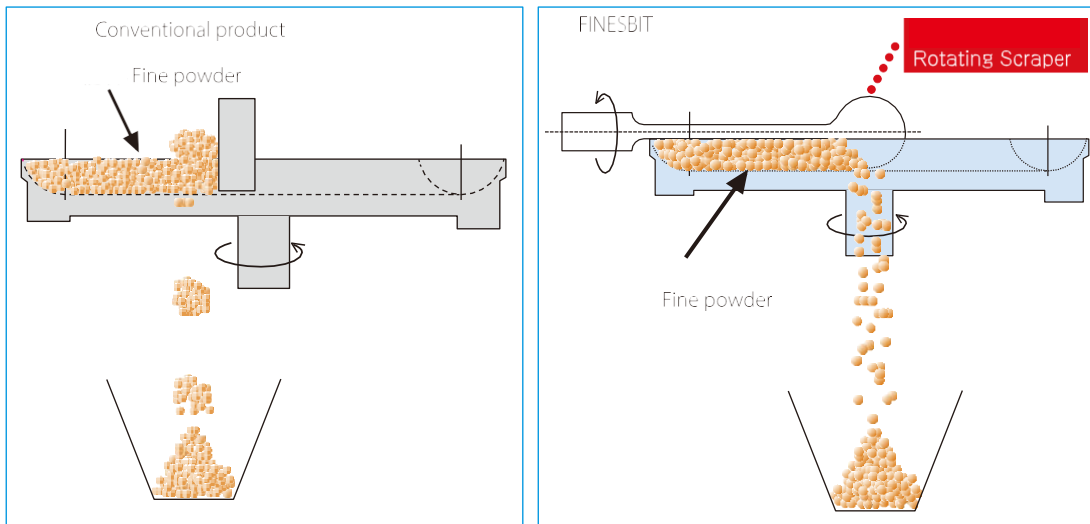

● Built-in Filling roller

Simple force filling makes uneven feeding and is easy to make bridges. Table feeder agitator arms have limitation of even feedings. Instead, FINESBIT has built-in filling roller to greatly improve even feedings.

● Touch-panel display as standard control panel

● Application

Food processing / Automotive / Machinery / Chemical / Mining / Recycle / Precision / Battery / etc.

FINESBIT

**Case Example**

No	Materials	(Ave)g/h Feeding Capacity	Std. dev $\sigma$ (Feeding Volume/min)	CV Coefficient variation (%)
1	JIS 11 Types Kanto Loam as Standard Materia	120.8	0.0356	2.10
2		229.3	0.0499	1.31
3		561.1	0.0922	1.06
4		1001.3	0.4594	2.75
1	JIS 10 Types Fly Ash as Standard Materia	91.8	0.0454	2.97
2		171.4	0.0494	1.73
3		318.2	0.0722	1.36
4		809.4	0.2870	2.13

**Specifications**

Model	FB-1000
Feeding Range (g/h)	100~1000
Feeding Accuracy (%)	1.0~3.0
Hopper Capacity (cc)	1000
Weight (kg)	5.0
Power Demand	100AC (50/60Hz)
Electric Capacity (VA)	300
Accessories	Weigh Module

\* Chart 1 shows the measurement result of ultrafine powder, Kanto loam (JIS 11 types) and Fly ash (JIS 10 types). It achieved measurement with absolute accuracy.

**Outline Dimensions**

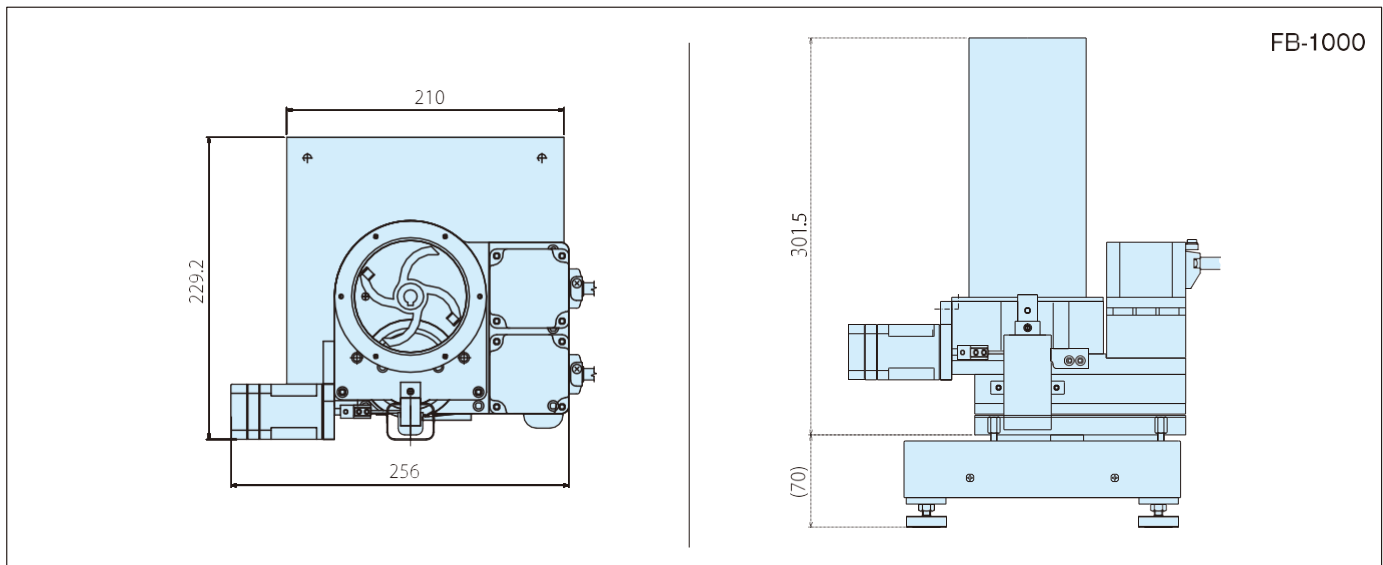

\*These specifications are subject to change without notice  
\*Please read the instruction manual carefully before use.



**KAWATA U.S.A., INC.**

**WWW.KAWATA-USA.COM**

Total Systems Engineer

**KAWATA MFG. CO., LTD.**

HEAD OFFICE /Phone.81-6-6531-8211 Fax.81-6-6531-8216

SALES OFFICE

(CHINA) KAWATA MACH. MFG. (SHANGHAI) CO., LTD.  
 □ Shanghai Office /Phone.86-21-6289-8989  
 □ Dalian Office /Phone.86-411-8753-8921  
 □ Tianjin Office /Phone.86-22-2370-7800  
 □ Shenzhen Office /Phone.86-755-8229-5250  
 □ Guangzhou Office /Phone.86-20-3402-5200

(HONG KONG) KAWATA MACHINERY (HK) LTD. /Phone.852-3118-1326

(TAIWAN R.O.C) TAIWAN KAWATA CO., LTD. /Phone.886-3-534-1847

(THAILAND) KAWATA (THAILAND) CO., LTD. /Phone.66-2-692-1331

(VIETNAM) KAWATA (THAILAND) CO., LTD. /Phone.84-4-22250155  
(Hanoi Representative Office)

(MALAYSIA) KAWATA MARKETING SDN. BHD. /Phone.60-6-765-6628

(SINGAPORE) KAWATA PACIFIC PTE. LTD. /Phone.65-6286-8817

(INDONESIA) PT. KAWATA MARKETING /Phone.62-21-5790-0852  
INDONESIA

(PHILIPPINES) KLAUTOMATION EQUIPMENT SALES & SERVICES

(Kawata (Thailand) Co., Ltd. Representative Office)  
/Phone.63-2-681-6174

INTERNATIONAL DIVISION /Phone.81-6-6531-2914 Fax.81-6-6531-8216

(U.S.A) CONAIR-KAWATA SALES & SERVICE CO /Phone.1-814-432-6368

(INDIA) PREVISION WORLD (INDIA) PVT. LTD.

□ Delhi Office /Phone.91-11-4653-8972 □ Chennai Office /Phone.91-44-4273-8662

□ Pune Office /Phone.91-20-6510-4700

(MEXICO) KAWATA-MACHINERY MEXICO S.A de C.V.

PLANT

(CHINA) KAWATA MACH. MFG. (SHANGHAI) CO., LTD. /Phone.86-21-6289-8989

(INDONESIA) PT. KAWATA INDONESIA /Phone.62-21-8984-4560

