

AUTOCOLOR COMPACT

Volumetric Batch Blender

Dryer suitable
for small molding machines



Standard Model, Compact Design



Compact size suitable for small and large molding machines

On-machine type requiring no machine-mounted hopper

Blower unit designed for space saving

Automatic suction of 3 kinds of material
(Note: Manual feeding for powder such as dry color)



A Blower unit with a control panel

Cassette-type table feeder for easy replacement (KTF for dry color, KTP for M/B)



Easy Material change

Easy calibration and cleaning, and quick color change



Material



Colorants

Easy calibration

Specifications

Model		AC-30C-KTP	AC-30C-KTF
Capacity		max. 30kg/h	
Hopper		SUS304	
		Virgin Material : 5.4L	
		Regrind Material : 4.4L	
Feeding System		Screw Feeder	
		Weighing Accuracy	
		Virgin Material : Within $\pm 1\%$	
		Regrind Material : Within $\pm 5\%$	
Table Feeder		KTP for M/B	KTF for Dry Color
		SUS Hopper : 2L SUS	
		Weighing Accuracy : Within $\pm 3\%$	
Mixing		SUS304 Drum : 2L SUS 304	
		Motor : 0.1kW \times 4P	
Blower Unit		Blower / Filter Box / Control Panel	
Conveying blower capacity		Blower : 0.55/0.85 kW (50/60Hz)	
Weight		Main Body : 45kg	
		Blower Unit : 60kg	
AC200V/220V 50/60Hz) Power Suppl(3 phase AC200V/220V 50/60Hz)		0.8/1.1kW 1.6/1.9kVA 20AT	
Compressed air		Pressure : 0.4~0.6MPa	
		Air consumption : 0.2L/min (ANR)	
		3-Way Air Selector	
		Power cable : 5 m	
Accessories	PVC Flexible Hose	A: $\phi 25 \times 5m \times 1p$ B: $\phi 38 \times 5m \times 1p$ M/B : $\phi 25 \times 5m \times 1p$ Blower Unit : $\phi 38 \times 5m \times 1p$	A: $\phi 25 \times 5m \times 1p$ B: $\phi 38 \times 5m \times 1p$ Blower Unit : $\phi 38 \times 5m \times 1p$
	Suction Pipe	$\phi 25 \times 500mm \times 2p$ $\phi 38 \times 650mm \times 1p$	$\phi 25 \times 500mm \times 1p$ $\phi 38 \times 650mm \times 1p$

Options

- ▷ Screw for A material SUS304
- ▷ Screw for B material SUS304
- ▷ Large capacity of conveying blower
- ▷ Buffing inner surface of mixing drum
- ▷ Different supply voltage
- ▷ Warning light
- ▷ Blended material tank

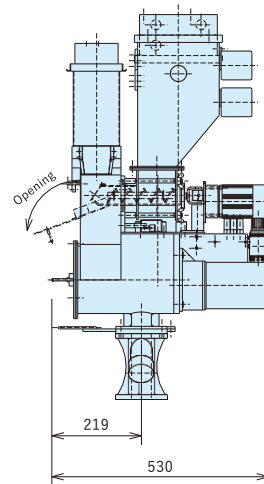
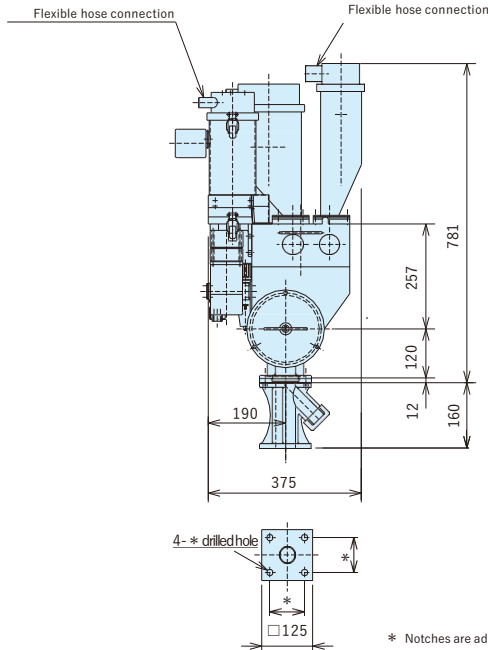
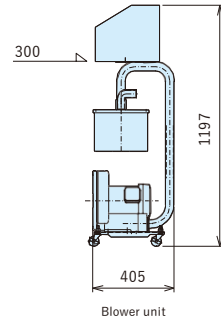
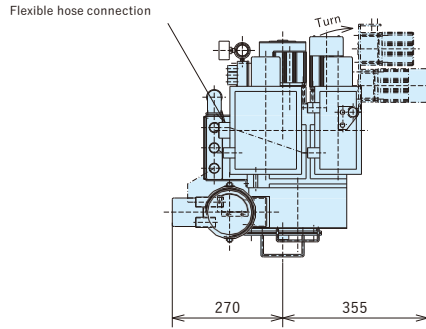

*These specifications are subject to change without notice.
*Please read the instruction manual carefully before use.

Total Systems Engineer

KAWATA U.S.A., INC. www.kawata-usa.com **KAWATA MFG. CO., LTD.**

Japan	HEAD OFFICE (International Division)	Phone:81-6-6531-8211 Fax:81-6-6531-8216 Phone:81-6-6531-2914 Fax:81-6-6531-8216
Sales Office		
China	KAWATA MACH. MFG. (SHANGHAI) CO., LTD.	Shanghai Office Phone:86-21-6289-8989 Fax:86-21-6279-1266 Dalian Office Phone:86-411-8753-8921 Fax:86-411-8753-8921 Tianjin Office Phone:86-22-2370-7800 Fax:86-22-2370-7801 Shenzhen Office Phone:86-755-8229-5250 Fax:86-755-8229-5251 Guangzhou Office Phone: 86-20-3402-5000 86-20-3402-5183
Hong Kong	KAWATA MACHINERY (HK) LTD.	Phone: 852-3118-1826 852-2545-0576
Taiwan R.O.C	TAIWAN KAWATA CO., LTD.	Phone:886-3-534-1847 Fax:886-3-534-1848
Thailand	KAWATA (THAILAND) CO., LTD.	Phone:66-2-692-1331 Fax:66-2-692-1332
Vietnam	KAWATA (THAILAND) CO., LTD. (Hanoi Representative Office)	Phone:84-4-22250155 Fax:84-4-22250156
Malaysia	KAWATA MARKETING SDN. BHD.	Phone:60-6-678-6666 Fax:60-6-678-4992
Singapore	KAWATA PACIFIC PTE. LTD.	Phone:65-6286-8817 Fax:65-6286-5519
Indonesia	KAWATA PACIFIC PTE. LTD. (Jakarta Representative Office)	Phone:62-21-7169-7346 Fax:62-21-535-8144
Philippines	KL AUTOMATION EQUIPMENT SALES & SERVICES (Kawata Thailand Co., Ltd. Representative Office)	Phone:63-2-681-6174
Germany	KAWATA EUROPE (Kawata Mfg. Co., Ltd. Liaison Office Europe)	Phone:49-6251-136990 Fax:49-6251-136991
U.S.A	CONAIR-KAWATA SALES & SERVICE CO.	Phone:1-814-432-6380 Fax:1-814-432-6267
India	PREVISION WORLD (INDIA) PVT. LTD.	Delhi Office Phone:91-11-4653-8972 Fax:91-11-4606-8355 Chennai Office Phone:91-44-4273-8661 Fax:91-44-4273-8662 Pune Office Phone:91-20-6510-4700 Fax:91-20-6614-1903
Plant		
China	KAWATA MACH. MFG. (SHANGHAI) CO., LTD.	Phone:86-21-3407-3260 Fax:86-21-3407-3261
Indonesia	PT. KAWATA INDONESIA	Phone:62-21-89844560 Fax:62-21-89844559